



C57

BAVARIA YACHTS

TECHNICAL DATA (approx.)

C57

Length over all	16,67 m	54,69 ft
Length over all incl. bowsprit	17,15 m	56,26 ft
Length hull	16,16 m	53,01 ft
Length waterline	15,62 m	51,24 ft
Beam of hull	5,28 m	17,32 ft
Draught standard	2,50 m	8,20 ft
Draught option	2,00 m	6,56 ft
Ballast standard	5.215 kg	11.497 lb
Ballast option	5.455 kg	12.026 lb
Displacement with deep keel 2,5 m	18.157 kg	40.029 lb
Displacement with shallow keel 2,0 m	19.163 kg	42.247 lb
Engine (standard)	80,9 kW / 110 PS	80,9 kW / 110 hp
Engine (standard)	Yanmar 4JH110	Yanmar 4JH110
Fuel tank (approx.)	440 L	96,8 gal ¹⁾
Water tank (approx.)	540 L	118,8 gal ¹⁾
Sail area total (standard)	136,5 m ²	1469,2 sq.ft
Mainsail (standard)	80,0 m ²	861,1 sq.ft
Mainsail (furling mast, vertical full battens)	76,0 m ²	818,7 sq.ft
Jib	56,5 m ²	608,1 sq.ft
Genoa	69,0 m ²	742,7 sq.ft
Gennaker	232,0 m ²	2497,2 sq.ft
Code 0	123,0 m ²	1323,9 sq.ft
Mast length (max.) from waterline excl. Windex	24,26 m	79,59
I	20,40 m	66,92 ft
J	6,20 m	20,34 ft
P	20,00 m	65,61 ft
E	6,88 m	22,57 ft
Cabins	3/5	3/5
Head	3/4	3/4
CE category	A15	A15
Design	Cossutti Yacht Design	

BASE PRICE EX WORKS (EXCL. VAT) – C57 HOLIDAY

525.800,00 €

BASE PRICE EX WORKS (EXCL. VAT) – C57 STYLE

546.930,00 €

¹⁾ [gal] imperial

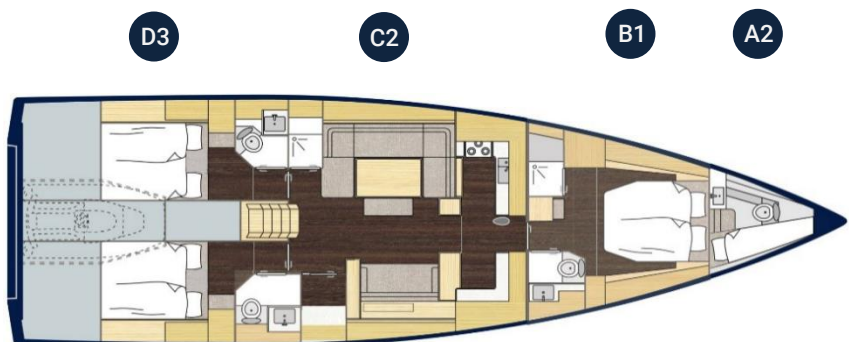
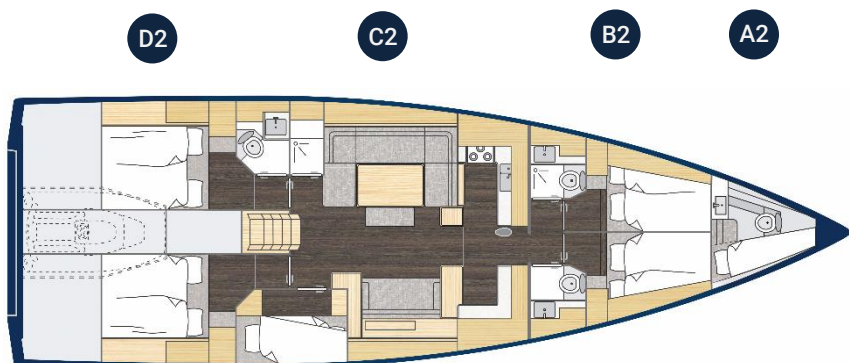
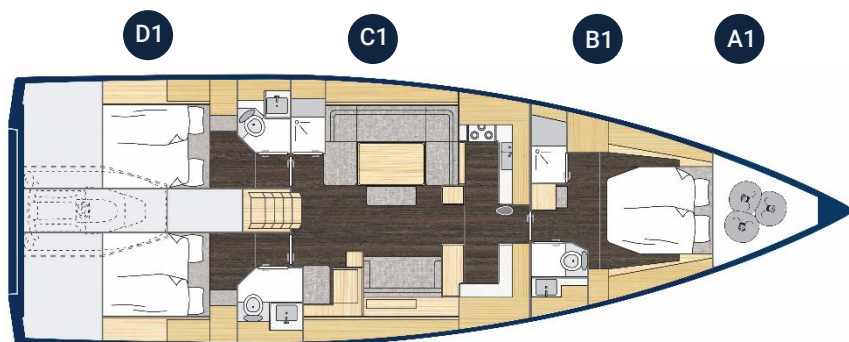

TRIM LEVEL EQUIPMENT	HOLIDAY	STYLE	C57
INTERIOR STYLING			
Headboard, fabric covered, in forward cabin (B1)		■	
Bed frames, fabric covered, in front and aft cabins		■	
Ceiling panels, fabric covered, in salon		■	
Chart table, leather covered		■	
Handrails, stainless steel, leather covered		■	
COCKPIT & DECK			
Rope storage boxes, at helm position		■	
INTERIOR EQUIPMENT			
Reading lights incl. USB charger, salon and cabins		■	
Handrail on ceiling in stainless steel with leather cover		■	
ELECTRICAL SYSTEMS			
Digital Switching System incl. 12" multifunction display at chart table with GPS function	■	■	

OPTIONAL PACKAGES	HOLIDAY	STYLE	Price excl. VAT	C57
SAIL READY PACK "HOLIDAY" (HP)				
PACKAGE CONTENTS	○	—	17.390,00 €	<input type="checkbox"/>
<div> <div> Battery extension, 6 x service batteries 95 Ah/12 V, AGM incl. charger 60 A and 40 A, (instead of 4 x service batteries 95 Ah / 12 V, AGM, and charger 60 A) Guard rail exit, both sides Anchor windlass, electrical Anchor, 32 kg, incl. chain (10 mm, 75 m), galvanized Courtesy lights in salon Curtains for coachroof and hull windows Blinds incl. mosquito nets for hatches in salon and cabins </div> <div> Deck vents, 2 x, on deck hatches LED lights in salon and cabins Mooring kit (8 fenders and 4 mooring lines) Reading lights incl. USB charger, salon and cabins Handrail on ceiling in stainless steel Stainless steel bow protection Cockpit shower with cold and warm water </div> </div>				
UPGRADES SAIL READY PACK "HOLIDAY" (HP-U)				
Bow thruster, tunnel, incl. additional battery 2 x 95 Ah / 12 V, AGM	○	—	10.120,00 €	<input type="checkbox"/>
Lithium Batterien, 3 x 185 Ah / 12V, LiFePO4 anstelle der AGM Service Batterien	○	—	8.980,00 €	<input type="checkbox"/>
Anchor, 32 kg, incl. chain (10 mm, 75 m), stainless steel	○	—	5.340,00 €	<input type="checkbox"/>
Anchor windlass with capstans	○	—	1.430,00 €	<input type="checkbox"/>
SAIL READY PACK "STYLE" (SP)				
PACKAGE CONTENTS	—	○	33.300,00 €	<input type="checkbox"/>
<div> <div> Bow thruster, tunnel, incl. additional battery 2 x 95 Ah / 12 V, AGM Teak on cockpit bottom Battery extension, 6 x service batteries 95 Ah/12 V, AGM incl. charger 60 A and 40 A, (instead of 4 x service batteries 95 Ah / 12 V, AGM, and charger 60 A) Guard rail exit, both sides Anchor windlass, electrical Anchor, 32 kg, incl. chain (10 mm, 75 m), galvanized Courtesy lights in salon and cockpit Curtains for coachroof and hull windows Blinds incl. mosquito nets for hatches in salon and cabins </div> <div> Deck vents, 2 x, on deck hatches LED lights in salon and cabins Mooring kit (8 fenders and 4 mooring lines) Ambient lights in salon and cabins, dimmable Extractor hood in galley Halyard winches, 2 pc., size 65, manual Cockpit table with small storage, 2 x, electrical lowerable to sun bathing area Cockpit shower with cold and warm water </div> </div>				
UPGRADES SAIL READY PACK "STYLE" (SP-U)				
Bow thruster, retractable, incl. additional battery 2 x 95 Ah / 12 V, AGM	—	○	9.990,00 €	<input type="checkbox"/>
Lithium Batterien, 4 x 150 Ah / 12V, LiFePO4 anstelle der AGM Service Batterien	—	○	10.500,00 €	<input type="checkbox"/>
Esthec on cockpit bottom	—	○	1.140,00 €	<input type="checkbox"/>
Anchor, 32 kg, incl. chain (10 mm, 75 m), stainless steel	—	○	5.340,00 €	<input type="checkbox"/>

Anchor windlass with capstans	—	○	1.430,00 €	<input type="checkbox"/>
Halyard winches, 2 x, size 65, electrical	—	○	6.450,00 €	<input type="checkbox"/>
NAVIGATION PACKAGES				
NAVIGATION PACKAGE “BASIC”	○	—	12.110,00 €	<input type="checkbox"/>
Instrument console (1 x per helm station) Display, 2 x B&G Triton² digital displays in cockpit; B&G Wind vane; DST800 Transducer for speed, depth and temperature Multi function display, B&G Zeus³S 9" with integrated GoFree™ Wi-Fi; all-weather touch screen and expanded keypad	VHF, B&G V60 with integrated AIS Receiver at chart table Autopilot B&G, incl. compass Autopilot B&G, control unit at helmstation stb Autopilot B&G, wireless remote control WR10			
NAVIGATION PACKAGE „ADVANCED”	○	○	20.160,00 €	<input type="checkbox"/>
Instrument console (1 x per helm station) Display, 4 x B&G Triton² digital displays in cockpit; B&G Wind vane; DST800 Transducer for speed, depth and temperature Multi function display, 2 x B&G Zeus³S 9" with integrated GoFree™ Wi-Fi; all-weather touch screen and expanded keypad, one per helm station	VHF, B&G V60 with integrated AIS Receiver at chart table VHF, B&G H60 wireless handset Autopilot B&G, incl. compass Autopilot B&G, control unit at helmstation stb Autopilot B&G, wireless remote control WR10			
NAVIGATION PACKAGE “PREMIUM”	—	○	26.150,00 €	<input type="checkbox"/>
Instrument console (1 x per helm station) Display, 2 x B&G H5000 graphic displays (1 x per helmstation); B&G Wind vane; DST800 Transducer for speed, depth and temperature Multi function display, 2 x B&G Zeus³S 12" with integrated GoFree™ Wi-Fi; all-weather touch screen and expanded keypad, one per helmstation NMEA engine information interface for chart plotter	VHF, B&G V60 with integrated AIS Receiver at chart table VHF, B&G H60 wireless handset Autopilot B&G, incl. compass Autopilot B&G, H5000 controll unit (1 x per helmstation) Autopilot B&G, Triton Edge Sailing Processor Autopilot B&G, wireless remote control WR10			
UPGRADES ELECTRONIC NAVIGATION PACKAGE				
Radar B&G Halo 20+	○	○	3.840,00 €	<input type="checkbox"/>
Depth sounder, B&G ForwardScan	—	○	1.760,00 €	<input type="checkbox"/>
AIS transponder, B&G NAIS-400 class B transponder	○	○	1.530,00 €	<input type="checkbox"/>
ENTERTAINMENT PACKAGE “BASIC”				
PACKAGE CONTENTS	○	○	2.980,00 €	<input type="checkbox"/>
Radio entertainment system Fusion MS-RA770 Apollo Marine with DAB+ and 2 speakers in salon	Fusion ERX400 Apollo remote control with 2 speakers in cockpit			
UPGRADES ENTERTAINMENT PACKAGE “BASIC”				
ENTERTAINMENT PACKAGE "OWNER" Radio entertainment system Fusion MS-R670 and 2 speakers in foreship cabin (only with B1)	—	○	1.230,00 €	<input type="checkbox"/>
TV preparation in salon, incl. TV lift system	○	○	2.140,00 €	<input type="checkbox"/>

INDIVIDUAL OPTIONS		HOLIDAY	STYLE	Price excl. VAT	C57
HULL / KEEL					
STANDARD					
Hull in sandwich construction, hull colour white		Keel, L-shape, cast iron, draft 2,52 m			
OPTIONS					
Hull colour silk grey with hull stripe white	<input type="radio"/>	<input type="radio"/>	6.800,00 €	<input type="checkbox"/>	
Hull stripe, dark blue (hull white or silk grey)	<input checked="" type="radio"/>	<input type="radio"/>	1.720,00 €	<input type="checkbox"/>	
Hull stripe, silk grey (hull white)	<input type="radio"/>	<input checked="" type="radio"/>	1.720,00 €	<input type="checkbox"/>	
Hull stripe, dark grey (hull white or silk grey)	<input type="radio"/>	<input type="radio"/>	1.720,00 €	<input type="checkbox"/>	
Hull stripe, jet black (hull white or silk grey)	<input type="radio"/>	<input type="radio"/>	1.720,00 €	<input type="checkbox"/>	
Keel, L-shape, cast iron, draft 1,99 m	<input type="radio"/>	<input type="radio"/>	3.920,00 €	<input type="checkbox"/>	
PROPULSION & STEERING SYSTEM					
STANDARD					
Diesel, 81 kW / 110 hp, shaft drive 3 blade fixed propeller Engine throttle, mechanical, mounted on helm station starboard		Twin wheel steering system GRP twin rudder with aluminum stock Steering wheel, stainless steel with leather cover			
OPTIONS					
Engine throttle, electric, mounted on steering pedestal stb. (only with navigation package)	<input type="radio"/>	<input type="radio"/>	8.520,00 €	<input type="checkbox"/>	
Engine throttle, electric, mounted on steering pedestal ps. (only with engine throttle, electric stb)	<input type="radio"/>	<input type="radio"/>	4.520,00 €	<input type="checkbox"/>	
Propeller, folding, 3 blades	<input type="radio"/>	<input type="radio"/>	2.740,00 €	<input type="checkbox"/>	
Stern thruster incl. 2 x 95 Ah battery, retractable (only with bow thruster retractable)	—	<input type="radio"/>	19.090,00 €	<input type="checkbox"/>	
Steering wheel, composite, black or white	<input type="radio"/>	<input type="radio"/>	1.950,00 €	<input type="checkbox"/>	
Steering wheels covers	—	<input type="radio"/>	1.160,00 €	<input type="checkbox"/>	
STANDING AND RUNNING GEAR					
STANDARD					
Conventional mast, keel stepped, 2 spreader, aluminum Jib furling system, above deck, manual Rod kicker Backstay adjuster, hydraulic		Midboom sheeting system Elvström Cruisetech Dacron - Mainsail, short battened with 2 reefs - self tacking jib, no battens Halyard winches, 2 x, size 55, manual			
OPTIONS CONVENTIONAL MAST					
Elvström Cruisetech Dacron - Mainsail, full battened with 2 reefs and MDS slider (replacing standard main sail)	<input type="radio"/>	<input type="radio"/>	1.670,00 €	<input type="checkbox"/>	
Elvström Ekko-Tech laminate - Mainsail, full battened with 2 reefs and MDS slider- self tacking jib, vertical battened	<input type="radio"/>	<input type="radio"/>	10.500,00 €	<input type="checkbox"/>	
Lazy bag with lazy jacks for mainsail	<input type="radio"/>	<input type="radio"/>	1.780,00 €	<input type="checkbox"/>	
OPTIONS FURLING MAST					
Furling mast, keel stepped 2 spreader, aluminium incl. upgrade to Cruisetech Dacron furling mainsail.	<input type="radio"/>	<input type="radio"/>	4.610,00 €	<input type="checkbox"/>	
Furling mast, electrical, keel stepped, 2 spreader, aluminium incl. upgrade to Cruisetech Dacron furling mainsail. Jib furling system, electrical. Synchronized electrical halyard winch Selden E60 on ps, electrical halyard winch Lewmar Evo AEST 65.	<input type="radio"/>	<input type="radio"/>	40750,00 €	<input type="checkbox"/>	
Elvström Cruisetech Dacron UPGRADE – furling mainsail, vertically full battened – self-tacking jib	<input type="radio"/>	<input type="radio"/>	2.240,00 €	<input type="checkbox"/>	
Elvström Ekko-Tech laminate - furling mainsail, vertically full battened - self-tacking jib with vertical battens	<input type="radio"/>	<input type="radio"/>	11.450,00 €	<input type="checkbox"/>	
OPTIONS STANDING AND RUNNING GEAR					
Elvström genoa 106% - Cruisetech Dacron (only with genoa tracks)	<input type="radio"/>	<input type="radio"/>	5.628,00 €	<input type="checkbox"/>	
Elvström genoa 106%, vertical batten - Ekko-Tech (only with genoa tracks)	<input type="radio"/>	<input type="radio"/>	7.371,00 €	<input type="checkbox"/>	
Genoa tracks with pin stop cars	<input type="radio"/>	<input type="radio"/>	1.990,00 €	<input type="checkbox"/>	
Elvström gennaker incl. snuffer and gennaker gear (halyard, sheets, blocks, halyard clutch and pad eye)	<input type="radio"/>	<input type="radio"/>	8.750,00 €	<input type="checkbox"/>	
Elvström permanent Code 0 and gear (halyard, sheets, blocks, halyard clutch and pad eye for code 0 tack / only with bowsprit)	<input type="radio"/>	<input type="radio"/>	10.550,00 €	<input type="checkbox"/>	
Mast step	<input type="radio"/>	<input type="radio"/>	740,00 €	<input type="checkbox"/>	
Spreader lights, 4 pcs.	—	<input type="radio"/>	1.660,00 €	<input type="checkbox"/>	

GRP bowsprit (black or white / recommended for gennaker and code 0)	○	○	4.940,00 €	<input type="checkbox"/>	
Organizer at halyard winches	—	○	2.650,00 €	<input type="checkbox"/>	

OPTIONS WINCHES					
Halyard winches, 2 x, size 65, manual	○	○	2.840,00 €	<input type="checkbox"/>	SP
Halyard winches, 2 x, size 65, electrical	○	○	6950,00 €	<input type="checkbox"/>	SP-U
Genoa/gennaker/code0 winches, 2 x, size 55, manual	○	○	3.440,00 €	<input type="checkbox"/>	
Genoa winches, 2 x, size 65, manual	○	○	4.650,00 €	<input type="checkbox"/>	
Genoa winches, 2 x, size 65, electrical	○	○	9.250,00 €	<input type="checkbox"/>	

DECK FLOORING					
STANDARD					
Teak on cockpit benches and bathing platform					
OPTIONS					
Teak on cockpit bottom	○	○	6.030,00 €	<input type="checkbox"/>	SP
Teak on side decks	○	○	22.380,00 €	<input type="checkbox"/>	
Teak on coachroof	—	○	8.390,00 €	<input type="checkbox"/>	
Esthec on cockpit benches and bathing platform	○	○	2.800,00 €	<input type="checkbox"/>	
Esthec on cockpit bottom	○	○	6.000,00 €	<input type="checkbox"/>	
Esthec on side decks	○	○	22.200,00 €	<input type="checkbox"/>	
Esthec on coachroof	—	○	8.300,00 €	<input type="checkbox"/>	

COCKPIT & DECK						
STANDARD						
Deck in sandwich construction, cockpit floor, side decks and coach roof with non-slip structure Deck flush hatches Cockpit table with small storage, 2 x, fix		Dedicated life raft storage in cockpit floor Bow fitting with anchor roller, stainless steel Mooring cleats, 6 x, stainless steel, fix				
OPTIONS COCKPIT & DECK						
Cockpit tables with small storage, 2 x, electrical, lowerable to sun bathing area	—	○	4.620,00 €	<input type="checkbox"/>	SP	
Drawer fridge incl. compressor at wet bar, 20 L (only in combination with E2 and BBQ)	○	○	1.690,00 €	<input type="checkbox"/>		
BBQ (gas) with sink and water tap in wet bar (only in combination with E2)	○	○	2.620,00 €	<input type="checkbox"/>		
Guard rail exit, both sides	○	○	1.420,00 €	<input type="checkbox"/>	HP, SP	
Guard rail exit ladder, aluminium	○	○	790,00 €	<input type="checkbox"/>		
Teak pushpit seats, foldable	—	○	1.430,00 €	<input type="checkbox"/>		
Mooring cleats, 6 x, aluminum, retractable	—	○	4.590,00 €	<input type="checkbox"/>		
Stainless steel bow protection	○	○	570,00 €	<input type="checkbox"/>	HP	
LFS - safety package	○	○	360,00 €	<input type="checkbox"/>		
Live saving collar with attachment and life line at pushpit	○	○	430,00 €	<input type="checkbox"/>		

OPTIONS COCKPIT UPHOLSTERY					
Cockpit cushions incl. backrests	—	○	5.620,00 €	<input type="checkbox"/>	
Sun bed cushions on coachroof incl. headrest and cup holders	○	○	2.150,00 €	<input type="checkbox"/>	
Sun bed cushions on foredeck incl. headrest and cup holders	○	○	2.260,00 €	<input type="checkbox"/>	

OPTIONS HOODS					
Bimini top	○	○	5.050,00 €	<input type="checkbox"/>	
Bimini top with solar panels, 348 Wp	○	○	8.950,00 €	<input type="checkbox"/>	
Sprayhood with handhold	○	○	3.700,00 €	<input type="checkbox"/>	
Grp Hardtop (white) with integrated softtop	○	○	31.900,00 €	<input type="checkbox"/>	
Sprayhood for grp hardtop (only with grp hardtop)	○	○	4.500,00 €	<input type="checkbox"/>	
Campercover for grp hardtop (only with sprayhood for grp hardtop)	○	○	3.950,00 €	<input type="checkbox"/>	
Solar panels, 696 Wp, for grp hardtop. Charging of service batteries (only with grp hardtop)	○	○	10.500,00 €	<input type="checkbox"/>	
Cockpit tables cover	—	○	1.070,00 €	<input type="checkbox"/>	

BATHING PLATFORM				
STANDARD				
Bathing platform, electric				
OPTIONS				
Tender launching system (incl. rollers and electrical winch, only with E2 dinghy garage)	<input type="radio"/>	<input type="radio"/>	5.860,00 €	<input type="checkbox"/>
Wireless remote control for bathing platform	<input type="radio"/>	<input type="radio"/>	1.580,00 €	<input type="checkbox"/>
12 V air compressor at transom for dinghy or toys (only with E2 Layout)	<input type="radio"/>	<input type="radio"/>	920,00 €	<input type="checkbox"/>

INTERIOR LAYOUT					
STANDARD					
A1: Sail locker B1: Queen size "island" double berth, storage, separate head and shower stall C1: Salon incl. U shaped galley, dining area on port, lounge area and chart table on stb (only with D1) D1: 2 Twin cabins with "scissor" bed aft, incl. ensuite head and separate shower stall on port and separate head on stb (only with C1)			E1: Storage space for toys and equipment under cockpit, access via cockpit floor hatch Companion way with washboard and sliding hatch in acrylic glass, lockable Salon dining table		
OPTIONS					
A2: Crew cabin with sink, toilet and storage space, 25 L holding tank	<input type="radio"/>	<input type="radio"/>	7.890,00 €	<input type="checkbox"/>	
B2: 2 Forward cabins, each cabin with double bed and storage, flex bulkhead system, 2 heads	<input type="radio"/>	<input type="radio"/>	8.640,00 €	<input type="checkbox"/>	
C2: Salon incl. galley, dining area on port and lounge area on stb (only with D2, D3)	<input type="radio"/>	<input type="radio"/>	no charge	<input type="checkbox"/>	
D2: 2 Aft cabins, incl. separate head and shower stall on port and bunk cabin stb (only with C2)	<input type="radio"/>	<input type="radio"/>	1.660,00 €	<input type="checkbox"/>	
D3: 2 Aft cabins, incl. separate head and shower stall on port and utility room stb (only with C2)	<input type="radio"/>	<input type="radio"/>	1.660,00 €	<input type="checkbox"/>	
E2: Dinghy garage, large longitudinal version (max. 2,8 m jet tender)	<input type="radio"/>	<input type="radio"/>	5.250,00 €	<input type="checkbox"/>	
Additional bunk bed for A2 layout (180 cm)	<input type="radio"/>	<input type="radio"/>	2.210,00 €	<input type="checkbox"/>	
Salon table, lowerable, electrical, convertible into double berth incl. cushion	<input type="radio"/>	<input type="radio"/>	3.460,00 €	<input type="checkbox"/>	
Director's chair, 2 x (replacing bench in salon)	—	<input type="radio"/>	1.970,00 €	<input type="checkbox"/>	

INTERIOR STYLING				
STANDARD				
Wood color, Mahogany Floor, Elm Worktop in galley, laminated, "Brown stone"	Upholstery "Vela" in salon Standard mattresses for all berths			
OPTIONS STYLING				
Wood color, Mahogany	■	■	Standard	<input type="checkbox"/>
Wood color, American Walnut	○	○	8.240,00 €	<input type="checkbox"/>
Wood color, Nordic Oak	○	○	8.980,00 €	<input type="checkbox"/>
Floor, Elm	■	■	Standard	<input type="checkbox"/>
Floor, Wenge	○	○	1.240,00 €	<input type="checkbox"/>
Floor, Ocean Line	○	○	2.110,00 €	<input type="checkbox"/>
Worktop in galley, laminated, "Pure white stone"	○	—	1.060,00 €	<input type="checkbox"/>
Worktop in galley, solid worktop "Staten Island Stone"	—	○	3.630,00 €	<input type="checkbox"/>
Worktop in galley, solid worktop "Canvas Mist"	—	○	3.630,00 €	<input type="checkbox"/>
OPTIONS UPHOLSTERY				
Upholstery "Heritage" in salon, fabric	○	○	1.660,00 €	<input type="checkbox"/>
Upholstery "Opus" in salon, artificial leather	○	○	1.760,00 €	<input type="checkbox"/>
Upholstery "Savoy" in salon, leather	—	○	6.200,00 €	<input type="checkbox"/>
Cold foam mattress with memory top for all berths 3 cabins	○	○	3.700,00 €	<input type="checkbox"/>
Cold foam mattress with memory top for all berths 4 cabins	○	○	3.920,00 €	<input type="checkbox"/>
Cold foam mattress with memory top for all berths 5 cabins	○	○	4.150,00 €	<input type="checkbox"/>

INTERIOR EQUIPMENT – GALLEY						
STANDARD						
Fridge in galley, 110L, top loading			3 burner stove with oven			
OPTIONS						
Microwave, 230 V, (powered by Generator or Shore-Power)	<input type="radio"/>	<input type="radio"/>	780,00 €	<input type="checkbox"/>		
Microwave preparation, 110V, (powered by Generator or Shore-Power)	<input type="radio"/>	<input type="radio"/>	410,00 €	<input type="checkbox"/>		
Dishwasher drawer 230 V (not in combination with cooled and sparkling water)	<input type="radio"/>	<input type="radio"/>	3.800,00 €	<input type="checkbox"/>		
Drawer fridge incl. Freezer unit totalling 160 L (replacing standard fridge)	<input type="radio"/>	<input type="radio"/>	3.660,00 €	<input type="checkbox"/>		
Fridge in galley	<input type="radio"/>	<input type="radio"/>	1.780,00 €	<input type="checkbox"/>		
Dedicated space for coffee machine incl. 220 V socket	<input type="radio"/>	<input type="radio"/>	260,00 €	<input type="checkbox"/>		
Purified drinking water with UVC-LED technology in pantry	<input type="radio"/>	<input type="radio"/>	1.350,00 €	<input type="checkbox"/>		
Cooled and sparkling water at the pantry tap (only with purified drinking water - not in combination with dishwasher drawer, only with 230V, powered by Generator or Shore-Power)	<input type="radio"/>	<input type="radio"/>	2.790,00 €	<input type="checkbox"/>		
INTERIOR EQUIPMENT – ELECTRICAL SYSTEM						
STANDARD						
Country version EU 230 V socket in each cabin Engine battery, 1 x 96 Ah / 12 V, AGM		Service battery, 4 x 95 Ah / 12 V, AGM Battery charger, 60 Ah (3 channels) Shore power 230 V				
OPTIONS						
Battery extension, additional service battery, 2 x 95 Ah /12 V, AGM incl. additional charger 40 A	<input type="radio"/>	<input type="radio"/>	1.160,00 €	<input type="checkbox"/>	HP, SP	
Inverter 2.500 W, 230 V (true sine wave)	<input type="radio"/>	<input type="radio"/>	3.400,00 €	<input type="checkbox"/>		
Inverter 2.000 W, 110 V (true sine wave)	<input type="radio"/>	<input type="radio"/>	3.400,00 €	<input type="checkbox"/>		
Diesel generator 6,4 kW, 230 V	<input type="radio"/>	<input type="radio"/>	23.740,00 €	<input type="checkbox"/>		
Diesel generator 8,0 kW, 230 V (recommended for Air conditioning)	<input type="radio"/>	<input type="radio"/>	27.990,00 €	<input type="checkbox"/>		
Diesel generator 6,4 kW, 110 V	<input type="radio"/>	<input type="radio"/>	28.190,00 €	<input type="checkbox"/>		
Diesel generator 8,0 kW, 110 V (recommended for Air conditioning)	<input type="radio"/>	<input type="radio"/>	32.440,00 €	<input type="checkbox"/>		
Shore power 110 V	<input type="radio"/>	<input type="radio"/>	4.220,00 €	<input type="checkbox"/>		
INTERIOR EQUIPMENT – WATER						
STANDARD						
40 L boiler 70 L holding tank, per toilet		Electric and manual bilge pump				
OPTIONS						
Fresh water dockside inlet	<input type="radio"/>	<input type="radio"/>	560,00 €	<input type="checkbox"/>		
Watermaker, 100 L/h, 12 V	<input type="radio"/>	<input type="radio"/>	16.500,00 €	<input type="checkbox"/>		
Washer/dryer, 6 kg, 220 V (only with D3 layout), (powered by Generator or Shore-Power)	<input type="radio"/>	<input type="radio"/>	3.120,00 €	<input type="checkbox"/>		
Washing machine, only preparation 110 V (incl. grey water tank, only with D3 layout), (powered by Generator or Shore-Power)	<input type="radio"/>	<input type="radio"/>	1.870,00 €	<input type="checkbox"/>		
Electric toilet (1 x) front cabin with fresh water flush system for B1 layout	<input type="radio"/>	<input type="radio"/>	1.250,00 €	<input type="checkbox"/>		
Electric toilet (2 x) front cabin with fresh water flush system for B2 layout	<input type="radio"/>	<input type="radio"/>	2.490,00 €	<input type="checkbox"/>		
Electric toilet (2x) aft cabin with fresh water flush system for D1 or D3 layout	<input type="radio"/>	<input type="radio"/>	2.490,00 €	<input type="checkbox"/>		
Electric toilet (1 x) aft cabin with fresh water flush system for D2 Layout	<input type="radio"/>	<input type="radio"/>	1.250,00 €	<input type="checkbox"/>		
Grey water system, totalling 180 L	<input type="radio"/>	<input type="radio"/>	4.090,00 €	<input type="checkbox"/>		
INTERIOR EQUIPMENT – CLIMATE CONTROL (HEATING AND AIR CONDITIONER ARE NOT COMBINABLE)						
OPTIONS						
Air Conditioner, Reverse Cycle, 22.000 BTU, 2 Units for foreship cabin and aft cabins, 230 V / 110 V (with 230V: incl. 2nd shore power)	<input type="radio"/>	<input type="radio"/>	19.500,00 €	<input type="checkbox"/>		
Air Conditioner, Reverse Cycle, 16.000 BTU, 2 Units for salon (incl. D2 cabin), 230 V / 110 V (with 230V: incl. 2nd shore power)	<input type="radio"/>	<input type="radio"/>	15.990,00 €	<input type="checkbox"/>		
Hot air heating, 8,0 kW, 2 Units for salon, foreship cabin(s) and aft cabins	<input type="radio"/>	<input type="radio"/>	9.060,00 €	<input type="checkbox"/>		

SHIPMENT

OPTIONS

Keel not mounted	<input type="radio"/>	<input type="radio"/>	630,00 €	<input type="checkbox"/>
Steel cradle for oversea transport	<input type="radio"/>	<input type="radio"/>	8.530,00 €	<input type="checkbox"/>
Steel cradle for oversea transport without keel (only with keel not mounted)	<input type="radio"/>	<input type="radio"/>	10.670,00 €	<input type="checkbox"/>
Shrink wrap	<input type="radio"/>	<input type="radio"/>	1.410,00 €	<input type="checkbox"/>

— Not available ■ Standard ○ Optional

Bavaria Yachtbau GmbH, Bavariastraße 1, D-97232 Giebelstadt, Phone +49 9334 942-0, Fax +49 9334 942-1160, www.bavariayachts.com, info@bavariayachts.com

All prices are in EURO and are valid only in conjunction and at the time of ordering a new yacht ex works Giebelstadt. All measurements and weights are calculations based upon design documents. The brochure is intended for advertisement only and is not part of a contract, warranty or of any offer. We reserve the right to modify or improve our products and to change specifications without notice. We reserve the right to replace the brands/manufacturers mentioned in the price list with equivalent products from other reputable manufacturers. We are not liable for errors and printing mistakes. Aforementioned prices are recommended sales prices for deliveries ex works within 4 months of order placement. Later deliveries are subject to invoicing according to the then valid price list.

Version: 2/2025

Valid from 01st February 2025

Publication: 15th January 2025 – The previous price list loses its validity.

Language/Taxes: English pricelist/all prices excl. VAT

