

LAGOON



A DREAM COME TRUE!

INGREECE





Presentation

LAGOON 560: INNOVATION THROUGH EXPERIENCE

practical design and on-deck safety
elegant and functional use of space
comfort and efficient performance

LAGOON EXPERTISE

infusion-moulding for increased weight saving (important for a catamaran), an optimal structure, and greater protection for the environment and shipbuilders
interior woodwork in Alpi® reconstituted wood
vertical glazing for better protection against the sun and optimal space and height below deck
gull-wing bridge deck with two steps for greater comfort in heavy seas
VPLP design: performance under sail guaranteed!
elegant and comfortable interiors by Nauta Design

ABOVE DECKS

the fly bridge is a veritable upper-deck saloon (access via closable stairway). Its helm station provides perfect visibility and includes a magnificent spot for sunbathing at the rear
the cockpit is fully protected from the sun and sea spray and is on the same level as the galley, saloon and chart table. Includes large sliding glass door
large and practical foredeck cockpit
transom platforms specially designed for safe boarding

BELOW DECKS

cabin layouts that break with the tradition of having the furniture fitted parallel to the hulls
the cockpit is directly accessible from the owner's cabin (starboard) and guest cabin (port)
owner's cabin includes office, separate washroom and direct access to the cockpit
guest cabins include VIP accommodation with separate washrooms
saloon includes L-shaped galley separated by a stowage unit that accommodates a TV set on the saloon side
chart table is forward facing and includes stowable electronics panels and control boards
natural light in cabins thanks to large hull windows
indirect lighting in saloon and cabins for soft lighting and the saloon windows can be fitted with blinds
engine compartments are far from the living areas and perfectly insulated



Features

2

1

Technical

Pair of hydraulic aluminium davits
Onam genset 17,5 KVA
Pack of 2 inverters 24/220V - 5000 VA
Watermaker 280 lt/hour
3 electrical winchers 70,2 on fly bridge

Navigation & Safety

Log/speedometer, Sounder, Anemometer Raymarine i70
Autopilot Raymarine
E165W chart plotter display at helm station
E125W chart plotter display at navigation station
AIS 650 Raymarine Transceiver
Radar HD Digital Raymarine 48NM
VHF Raymarine



3

Comfort

Reverse cycle centralized chilled water
Air conditioning 72.000 BTU
Fans for saloon & cabins
Indirect lighting in cabins & saloon
Bimini on helm station with LED lights
Sunlounger pads & cockpit cushions
Cockpit Fridge
Pack of 2 inverters 24/220V 5000VA
Electrical toilets
Additional freezer
Washer/dryer 5Kg MIELE
Dish washer 12 sets MIELE
TV HD in saloon & in the cabins
PlayStation® : PS4™, Blu-ray and games
RR mast antenna (TV, VHF, AM-FM, GSM)
Wi-Fi + 3G/4G when available
Radio CD MP3 player + loudspeakers in salon, cockpit, flybridge and all cabins

5 6 0

4

Water Sports

Dinghy with motor
Water skiing
2 person Kayak

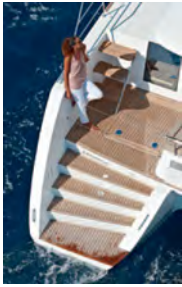

Specifications

Built year	2014
Naval architects	Van Peteghem-Lauriot Prévost
Interior design	Nauta Design
Length over all	17,07 m / 56'
Beam over all	9,44 m / 31'
Draft	1,50 m / 4'11"
Mast clearance	28,66 m / 94'
Light displacement (EEC)	30,3 t / 66812 Lbs
Engines	2 x 110 HP Yanmar
Fuel capacity	2 x 650 l / 2 x 172 US gal
Upwind sail area	207 m ² / 2227 sq.ft.
Fresh water capacity	4 x 240 l / 4 x 63 US gal
Guests	10

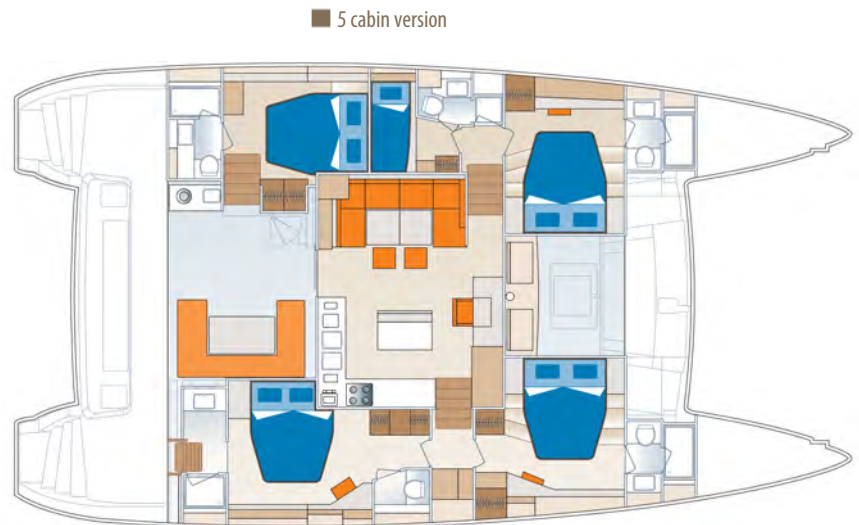

■ 4 double cabins and 1 upper/lower berth cabin
Separate crew cabins with own toilettes





■ 1 January - 24 April	€11.165	■ Fuel:	Extra charge at cost (average consumption 15lt/hour)
24 April - 22 May	€13.195	■ Inclusive in the prices:	Taxes
22 May - 19 June	€16.240		Harbour fees for the first and last charter night
19 June - 31 July	€17.255		Two or Three persons crew, (Skipper & one or two hostess/ cook)
31 July - 21 August	€19.498		
21 August - 28 August	€17.255		
28 August - 2 October	€16.240		
2 October - 31 December	€12.180		
■ Reductions:	10% for 2 or more weeks charter		
■ Embarkation:	16:00h any day of the week		
■ Disembarkation:	10:00h any day of the week		
■ Short period bookings:	5 days -> 80% of the weekly rate 4 days -> 65% of the weekly rate 3 days -> 55% of the weekly rate		
■ One-ways within Greece:	€3.500 surcharge		

560

7, Alimos Avenue
17455 Alimos, Greece
Tel. +30 210 9886187
Fax. +30 210 9817823
info@kiriacoulis.com
www.kiriacoulis.com

