

DEALER NAME

 End Customer :
 Address
 Zip code + City
 Country
 Email :
 7/9/2020

COMMISSION N°

NAUTITECH 46 FLY

BASED ON BUILDER STANDARD SPECIFICATIONS SEPTEMBER 8th 2020

	Prix C HT	Qté	Total
Base Price Ex Works - 3 Cabins / 3 Heads	469.700,00 €	0	
Base Price Ex Works - 4 Cabins / 4 Heads	474.300,00 €	0	
Extra for white oak interior wood instead of walnut	6.200,00 €	0	
COMFORT VERSION	20.400,00 €	0	
EXPLORER VERSION (price advantage 5%)	44.800,00 €	0	

Version configuration	COMFORT	EXPLORER
Anchor windlass (electric) with wired remote, 1500W	•	•
Cockpit shower with hot/cold water on Stb	•	•
Two Forward pulpits with seats in teak	•	•
Stainless steel davits for tender	•	•
Mooring Kit (8 Fenders with socks, 4 mooring lines)	•	•
230 V Electrical system with batteries for Service 2 x 12V/140Ah incl. 32A shorepower, system 230V with plugs in all cabins, saloon and galley and battery charger 40Ah, galvanic isolators	•	•
Top loading fridge 85L integrated into the galley worktop	•	•
Pack USB plugs (1 double plug per cabin)	•	•
Mosquito screens for all hatches on deck	•	•
FUSION audio system with 6 speakers	•	•
Cockpit table in GRP	•	•
Electrical winch at helmstation flybridge (main halyard, solent sheet, Reef 1&3) Middle	Option	•
Cushions for cockpit and flybridge	Option	•
Gennaker Reacher 98sqm, incl. Sheets	Option	•
Bow sprit & furler, tack line, dynema halyard, incl. deckware for gennaker	Option	•
Full cockpit enclosure with doors	Option	•
External sun shades for saloon windscreen (black) with opening	Option	•
Electrical sea water pump	Option	•

OPTIONS	Prix € HT	Qté	Total
MOTORISATION			
2 x 60hp Volvo Penta engines	4.500,00 €	0	- €
2 x 3-blade folding propellers, bronze 50 Hp	3.400,00 €	0	- €
2 x 3-blade folding propellers, bronze 60 Hp	3.600,00 €	0	- €
EQUIPEMENT DE NAVIGATION			
Lazy bag for standard mast	1.490,00 €	0	- €
Name of boat on Lazy bag	400,00 €	0	- €
Black (matt) painted mast and boom (not in combination with Furling mast)	4.700,00 €	0	- €
Furling mast (full batten mainsail replaced by furling mainsail, lazy bag not compatible)	5.200,00 €	0	- €
Hydranet main and fore sail (replaces standard sails)	11.300,00 €	0	- €
Gennaker Reacher 98sqm, incl. Sheets	4.790,00 €	0	- €
Bow sprit & furler, tack line, dynema halyard, incl. deckware for gennaker	5.590,00 €	0	- €
Electrical winch at helmstation flybridge(main halyard,solent sheet, Reef 1&3) Middle	3.470,00 €	0	- €
Electrical winch at helmstation flybridge (Gennaker halyard, Reef 2) Portside	3.470,00 €	0	- €
Electrical winch at helmstation flybridge (main sail sheet) Starboard	3.470,00 €	0	- €
GRP steering wheel, black	895,00 €	0	- €
Anchor windlass remote control with chaincounter at helm station	640,00 €	0	- €
UPHOLSTERY & LIFESTYLE			
Inside range choice			
Upgrade comfort mattress (3c version)	1.900,00 €	0	- €
Upgrade comfort mattress (4c version)	2.500,00 €	0	- €
Saloon cushions Standard	Standard		Standard
<input type="checkbox"/> Eden Nutmeg			
<input type="checkbox"/> Eden Pebble			
<input type="checkbox"/> Eden Shadow			
Saloon cushions Ultraleather	590,00 €	0	- €
<input type="checkbox"/> White			
<input type="checkbox"/> Beige			
<input type="checkbox"/> Taupe			
Saloon cushions Leather	1.800,00 €	0	- €
<input type="checkbox"/> Sand			
<input type="checkbox"/> Cappucino			
<input type="checkbox"/> Slate Gray			
Outside color choice:	Optionnel		
<input type="checkbox"/> Eden Nutmeg			
<input type="checkbox"/> Eden Pebble			
<input type="checkbox"/> Eden Shadow			
Signature			
Upgrade for In&Out SIGNATURE Upholstery with decorative cushions	1.900,00 €	0	- €
Set of custom bedding for 3 cabin-version	2.016,00 €	0	- €
Set of custom bedding for 4 cabin-version	2.648,00 €	0	- €
Set of 6 bathroom towels – white with Nautitech Manta Ray embroidery (2 guests, 2 toilets and 2 baths) - unit price per set	100,00 €	0	- €
Set of 8 socks for fender - Black with white Nautitech embroidery	440,00 €	0	- €
Upgrade of gennaker with printing of Nautitech Manta Ray (gold) and 46 (black)	2.790,00 €	0	- €
Upgrade for leather covered handrail in the companion way	470,00 €	0	- €
EXTERIOR EQUIPMENT			
Deck/Cockpit			
Synthetic-teak in cockpit and aft platforms	9.900,00 €	0	- €
Teak in cockpit and aft platforms	9.500,00 €	0	- €
Frontdeck Lounge: Bar/storage box for front deck lounge with integrated cupholders - Foldable 3 part cushions convertible into lounge area - 2 secret lights - teak cover on chain path	5.300,00 €	0	- €
Full cockpit enclosure with doors	4.100,00 €	0	- €
Additional sun net for cockpit enclosure (only together with cockpit enclosure)	1.280,00 €	0	- €
External sun shades for saloon windscreen (black) with opening	1.490,00 €	0	- €
Cushions for cockpit seats and aft bench	3.500,00 €	0	- €
Cockpit table convertible into lounge area (upholstery included)	1.900,00 €	0	- €
Cockpit table in teak 10 pers (1,73m X 0,79m)	1.520,00 €	0	- €
Plancha gaz on the cockpit back balcony with protection cover	2.500,00 €	0	- €
FLYBRIDGE			
Lounge coffee table convertible into sun bath (upholstery included)	2.700,00 €	0	- €
Bimini full flybridge	14.600,00 €	0	- €
Helmstation protection (steering wheel + console)	800,00 €	0	- €
Fridge drawer in flybridge 36L, 12V	1.690,00 €	0	- €
Cushions for flybridge and helmstation seat	3.700,00 €	0	- €
INTERIOR EQUIPMENT			
Blinds for cabin hull windows	1.590,00 €	0	- €
Saloon Blinds	6.900,00 €	0	- €
Saloon table foldable convertible into coffee table	2.370,00 €	0	- €
Saloon table convertible into lounge bed (manual - cushion included)	1.580,00 €	0	- €
Extra berth in portside forepeak incl. mattress, white gelcoat finishing, ventilation, light and access to front cabin (only with 4 Cabins version)	1.950,00 €	0	- €
Extra berth in starboard forepeak incl. mattress, white gelcoat finishing, ventilation, light and access to front cabin	1.950,00 €	0	- €
COMFORT & APPLIANCES			
Watermaker 60L/h 12V	13.500,00 €	0	- €
Watermaker 100L/h DUO- 12V/220V	16.900,00 €	0	- €
Electrical sea water pump	620,00 €	0	- €
Upgrade Flush 2 drawer stainless steel Fridge 104L /Freezer 78L (replaces 182L Fridge)	680,00 €	0	- €
Freezer 55L 12V in port hull	2.190,00 €	0	- €
Washing machine 3kg 220V in owner head (3 cabins version only)	1.990,00 €	0	- €
Dishwasher 220V 6pax	1.850,00 €	0	- €
Microwave oven 220V	290,00 €	0	- €
Fans 12V (1 per cabin / 2 in saloon)	990,00 €	0	- €
Reversible air-conditioning 230V (cooling + heating function /outlet in saloon and each cabin)	25.900,00 €	0	- €
Heating system, hot water (outlet in each cabin, heads, saloon and Cockpit)	13.500,00 €	0	- €
Electrical toilet, seawater flush (per unit - specify location)	940,00 €	0	- €
Electrical toilet, freshwater flush (per unit - specify location)	1.060,00 €	0	- €
ELECTRICITY & LIGHTING			

1 Additional service batterie 140A and charger 40A	1.600,00 €	0	- €
Inverter 2000W connected to boardnet incl. Switch	2.380,00 €	0	- €
(Additional service batterie 140A and charger 40A compulsory)			
Indirect lighting in saloon	990,00 €	0	- €
White courtesy LED lights in cockpit and aftdeck	1.200,00 €	0	- €
Two LED spreaders lights	890,00 €	0	- €
Two LED spotlights under the bridgedeck	1.850,00 €	0	- €
Underwaterlighting 2 x 21W White	3.800,00 €	0	- €
Solar panels 3 x 150 W on roof extension	4.590,00 €	0	- €
Generator ONAN 7KW + monitoring + maintenance kit	19.900,00 €	0	- €
NAVIGATION PACK & MULTIMEDIA			
Nav-Pack Cruise	13.200,00 €	0	- €
2 x B&G Triton Displays (1 at chart table /1 at fly helmstation) with Speed-, Depth-, Wind-Transducer			
2 x B&G Zeus 9" Chartplotter (1 at chart table /1 at fly helmstation)			
B&G Autopilot, B&G Autopilot control unit (fly helmstation)			
B&G V60 VHF incl. Antenna, AIS Transmitter/Receiver integrated (chart table)			
B&G H60 wireless VHF unit (fly helmstation)			
Nav-Pack Advanced	17.800,00 €	0	- €
<i>includes Nav-Pack Cruise plus additional</i>			
1 x extra B&G Autopilot control unit (1 at chart table /1 at fly helmstation)			
2 x B&G Zeus 12" chartplotter instead of 9" (1 at chart table /1 at fly helmstation)			
NMEA Connector for PC (chart table)			
B&G Forward scan			
B&G camera under flybridge	1.950,00 €	0	- €
B&G HALO 20+ Radar antenna	2.590,00 €	0	- €
Pre installation for TV 220V in saloon (antenna and plug)	990,00 €	0	- €
TV 220V in saloon incl. bracket, antenna	1.890,00 €	0	- €
TV 220V in owner cabin incl. bracket, antenna	1.890,00 €	0	- €
60 HZ OPTIONS			
Upgrade Electrical pack 110V	2.950,00 €	0	- €
Watermaker 100L/h DUO- 12V/110V	16.900,00 €	0	- €
Reversible air-conditioning 110V (cooling + heating function /outlet in saloon and each cabin)	26.400,00 €	0	- €
Generator ONAN + monitoring 9KVA-60Hz under 110V	22.300,00 €	0	- €
Inverter 2000W 110V connected to boardnet incl. Switch	2.380,00 €	0	- €
(Additional service batterie 140A and charger 40A compulsory)			
Pre installation for TV 110V in saloon	990,00 €	0	- €
Pre installation for TV 110V in owner cabin	990,00 €	0	- €
Pre installation washing machine	390,00 €	0	- €
Pre installation micro wave	180,00 €	0	- €
SAFETY EQUIPMENT AND DELIVERY			
20kg Delta-Anchor, galvanized, chain Ø 10mm, length 70m with crow's feet	1.390,00 €	0	- €
Dinghy 3,4m (Hypalon) with 15hp Honda outboard engine	10.900,00 €	0	- €
6 pax life raft cat. A with security pack for 6 crew	3.990,00 €	0	- €
12 pax Life raft cat. A with security pack for 12 crew	4.700,00 €	0	- €
Antifouling SEAJET PRO (cold water)	3.550,00 €	0	- €
Antifouling PLATINIUM (tropical water)	4.900,00 €	0	- €
Copper coat	7.700,00 €	0	- €
Delivery in La Rochelle Marina (1 week harbour incl.)	8.500,00 €	0	- €
Preparation for seafreight (mast in 2 parts)	3.630,00 €	0	- €
Administrative papers (without Francization taxes and export fees except T2L)	450,00 €	0	- €
Total excl. VAT			- €
20% deposit at order			- €
20% two months before delivery			- €
Balance 15 days before loading date EX Yard			- €

Estimated date of delivery : (will be confirmed upon reception of order):

REMARKS : Official schedule payment will be precised when delivery date will have been determined.

COMMENTS:

Requested delivery date:

**REMARK : Upon receipt of our order confirmation, please check and advise immediatly if any discrepancies.
The boat will be built according to this order confirmation**

The undersigned declares to agree with the order form and to accept general sales conditions to approve them and to buy the goods above.

NAUTITECH CATAMARANS SAS

The Customer

Signature with "read and approved" mention

All prices are in EUROS EX Works Rochefort (17300 - France) Incoterms 2000
Version 2/2020 - Valid as of SEPTEMBER 8th 2020
Date of issue : SEPTEMBER 8th 2020 - the previous price list loses its validity.

All weights and measurements are calculation based upon construction documents. The brochure is intended for advertisement only and is not part of a contract, warranty or of an offer. We reserve the right to modify or improve our products and to change its specifications without notice. We are not liable for errors and printing mistakes. All rights are reserved to execute alterations in construction and equipment without notice. Aforementioned prices are recommended sales prices for deliveries ex works within 4 months of order placement. Later deliveries are subject to invoicing according to the then valid price list. The current price includes the Ecotax APER.

NAUTITECH 46 FLY



Base Price Ex Works - 3 Cabins / 3 Heads

Price excl. VAT, EUROS
469.700,00 €

Base Price Ex Works - 4 Cabins / 4 Heads

474.300,00 €

Extra for white oak interior wood instead of walnut

6.200,00 €

COMFORT VERSION

20.400,00 €

EXPLORER VERSION (price advantage 5%)

44.800,00 €

Version configuration	COMFORT	EXPLORER
Anchor windlass (electric) with wired remote, 1500W	●	●
Cockpit shower with hot/cold water on Stb	●	●
Two Forward pulpits with seats in teak	●	●
Stainless steel davits for tender	●	●
Mooring Kit (8 Fenders with socks, 4 mooring lines)	●	●
230 V Electrical system with batteries for Service 2 x 12V/140Ah incl. 32A shorepower, system 230V with plugs in all cabins, saloon and galley and battery charger 40Ah, galvanic isolators	●	●
Top loading fridge 85L integrated into the galley worktop	●	●
Pack USB plugs (1 double plug per cabin)	●	●
Mosquito screens for all hatches on deck	●	●
FUSION audio system with 6 speakers	●	●
Cockpit table in GRP	●	●
Electrical winch at helmstation flybridge (main halyard, solent sheet, Reef 1&3) Middle	Option	●
Cushions for cockpit and flybridge	Option	●
Gennaker Reacher 98sqm, incl. Sheets	Option	●
Bow sprit & furler, tack line, dynema halyard, incl. deckware for gennaker	Option	●
Full cockpit enclosure with doors	Option	●
External sun shades for saloon windscreen (black) with opening	Option	●
Electrical sea water pump	Option	●

MOTORSATION

Price excl. VAT, EUROS

<input type="checkbox"/> 2 x 60hp Volvo Penta engines	4.500,00 €
<input type="checkbox"/> 2 x 3-blade folding propellers, bronze 50 Hp	3.400,00 €
<input type="checkbox"/> 2 x 3-blade folding propellers, bronze 60 Hp	3.600,00 €

EQUIPEMENT DE NAVIGATION		
<input type="checkbox"/>	Lazy bag for standard mast	1.490,00 €
<input type="checkbox"/>	Name of boat on Lazy bag	400,00 €
<input type="checkbox"/>	Black (matt) painted mast and boom (not in combination with furling)	4.700,00 €
<input type="checkbox"/>	Furling mast (full batten mainsail replaced by furling mainsail, lazy bag not compatible)	5.200,00 €
<input type="checkbox"/>	Hydranet main and fore sail (replaces standard sails)	11.300,00 €
VE <input type="checkbox"/>	Gennaker Reacher 98sqm, incl. Sheets	4.790,00 €
VE <input type="checkbox"/>	Bow sprit & furler, tack line, dynema halyard, incl. deckware for gennaker	5.590,00 €
VE <input type="checkbox"/>	Electrical winch at helmstation flybridge (main halyard, solent sheet, Reef 1&3) Middle side	3.470,00 €
<input type="checkbox"/>	Electrical winch at helmstation flybridge (gennaker halyard, Reef 2)	3.470,00 €
<input type="checkbox"/>	Electrical winch at helmstation flybridge (main sail sheet)	3.470,00 €
<input type="checkbox"/>	Starboard	3.470,00 €
<input type="checkbox"/>	GRP steering wheel, black	895,00 €
<input type="checkbox"/>	Anchor windlass remote control with chaincounter at helm station	640,00 €
UPHOLSTERY & LIFESTYLE		
Inside range choice		
<input type="checkbox"/>	Upgrade comfort mattress (3c version)	1.900,00 €
<input type="checkbox"/>	Upgrade comfort mattress (4c version)	2.500,00 €
<input type="checkbox"/>	Saloon cushions Standard	Standard
	<input type="checkbox"/> Eden Nutmeg	
	<input type="checkbox"/> Eden Pebble	
	<input type="checkbox"/> Eden Shadow	
<input type="checkbox"/>	Saloon cushions Ultraleather	590,00 €
	<input type="checkbox"/> White	
	<input type="checkbox"/> Beige	
	<input type="checkbox"/> Taupe	
<input type="checkbox"/>	Saloon cushions Leather	1.800,00 €
	<input type="checkbox"/> Sand	
	<input type="checkbox"/> Cappuccino	
	<input type="checkbox"/> Slate Gray	
<input type="checkbox"/>	Outside color choice:	Optionnel
	<input type="checkbox"/> Eden Nutmeg	
	<input type="checkbox"/> Eden Pebble	
	<input type="checkbox"/> Eden Shadow	
Signature		
<input type="checkbox"/>	Upgrade for In&Out SIGNATURE Upholstery with decorative cushions	1.900,00 €
<input type="checkbox"/>	Set of custom bedding for 3 cabin-version	2.016,00 €
<input type="checkbox"/>	Set of custom bedding for 4 cabin-version	2.648,00 €
<input type="checkbox"/>	Set of 6 bathroom towels - white with Nautitech Manita Ray embroidery (2 guests, 2 toilets and 2 baths), unit price per set	100,00 €
<input type="checkbox"/>	Set of 8 socks for fender - Black with white Nautitech embroidery	440,00 €
<input type="checkbox"/>	Upgrade of gennaker with printing of Nautitech Manita Ray (gold) and AK (black)	2.790,00 €
<input type="checkbox"/>	Upgrade for leather covered handrail in the companion way	470,00 €
EXTERIOR EQUIPMENT		
Deck/Cockpit		
<input type="checkbox"/>	Synthetic-teak in cockpit and aft platforms	9.900,00 €
<input type="checkbox"/>	Teak in cockpit and aft platforms	9.500,00 €
<input type="checkbox"/>	Frontdeck lounge: bar/storage box for front deck lounge with integrated cupholders -	
<input type="checkbox"/>	Foldable 3 part cushions convertible into lounge area - 2 secret lights - teak cover on chain path	5.300,00 €
VE <input type="checkbox"/>	Full cockpit enclosure with doors	4.100,00 €
<input type="checkbox"/>	Additional sun net for cockpit enclosure (only together with cockpit enclosure)	1.280,00 €
VE <input type="checkbox"/>	External sun shades for saloon windscreen (black) with opening	1.490,00 €
VE <input type="checkbox"/>	Cushions for cockpit seats and aft bench	3.500,00 €
<input type="checkbox"/>	Cockpit table convertible into lounge area (upholstery included)	1.900,00 €
<input type="checkbox"/>	Cockpit table in teak 10 pers (1,73m X 0,79m)	1.520,00 €
<input type="checkbox"/>	Plancha gaz on the cockpit back balcony with protection cover	2.500,00 €
FLYBRIDGE		
<input type="checkbox"/>	Lounge coffee table convertible into sun bath (upholstery included)	2.700,00 €
<input type="checkbox"/>	Bimini full flybridge	14.600,00 €
<input type="checkbox"/>	Helmstation protection (steering wheel + console)	800,00 €
<input type="checkbox"/>	Fridge drawer in flybridge 36L, 12V	1.690,00 €
VE <input type="checkbox"/>	Cushions for flybridge and helmstation seat	3.700,00 €

INTERIOR EQUIPMENT		Price excl. VAT, EUROS
<input type="checkbox"/>	Blinds for cabin hull windows	1.590,00 €
<input type="checkbox"/>	Saloon Blinds	6.900,00 €
<input type="checkbox"/>	Saloon table foldable convertible into coffee table	2.370,00 €
<input type="checkbox"/>	Saloon table convertible into lounge bed (manual - cushion included)	1.580,00 €
<input type="checkbox"/>	Extra berth in portside forepeak incl. mattress, white gelcoat finishing, ventilation, light and access to front cabin (only with 4 Cabins version)	1.950,00 €
<input type="checkbox"/>	Extra berth in starboard forepeak incl. mattress, white gelcoat finishing, ventilation, light and access to front cabin	1.950,00 €
COMFORT & APPLIANCES		
<input type="checkbox"/>	Watermaker 60L/h 12V	13.500,00 €
<input type="checkbox"/>	Watermaker 100L/h DUO- 12V/220V	16.900,00 €
<input type="checkbox"/>	Electrical sea water pump	620,00 €
<input type="checkbox"/>	Upgrade Flush 2 drawer stainless steel Fridge 104L /Freezer 78L (replaces 182L Fridge)	680,00 €
<input type="checkbox"/>	Freezer 55L 12V in port hull	2.190,00 €
<input type="checkbox"/>	Washing machine 3kg 220V in owner head (3 cabins version only)	1.990,00 €
<input type="checkbox"/>	Dishwasher 220V 6pax	1.850,00 €
<input type="checkbox"/>	Microwave oven 220V	290,00 €
<input type="checkbox"/>	Fans 12V (1 per cabin / 2 in saloon)	990,00 €
<input type="checkbox"/>	Reversible air-conditioning 230V (cooling + heating function /outlet in saloon and each cabin)	25.900,00 €
<input type="checkbox"/>	Heating system, hot water (outlet in each cabin, heads, saloon and Cockpit)	13.500,00 €
<input type="checkbox"/>	Electrical toilet, seawater flush (per unit - specify location)	940,00 €
<input type="checkbox"/>	Electrical toilet, freshwater flush (per unit - specify location)	1.060,00 €
ELECTRICITY & LIGHTING		
<input type="checkbox"/>	1 Additional service batterie 140A and charger 40A	1.600,00 €
<input type="checkbox"/>	Inverter 2000W connected to boardnet incl. Switch (Additional service batterie 140A and charger 40A compulsory)	2.380,00 €
<input type="checkbox"/>	Indirect lighting in saloon	990,00 €
<input type="checkbox"/>	White courtesy LED lights in cockpit and aftdeck	1.200,00 €
<input type="checkbox"/>	Two LED spreaders lights	890,00 €
<input type="checkbox"/>	Two LED spotlights under the bridgedeck	1.850,00 €
<input type="checkbox"/>	Underwaterlighting 2 x 21W White	3.800,00 €
<input type="checkbox"/>	Solar panels 3 x 150 W on roof extension	4.590,00 €
<input type="checkbox"/>	Generator ONAN 7KW + monitoring + maintenance kit	19.900,00 €
NAVIGATION PACK & MULTIMEDIA		
<input type="checkbox"/>	Nav-Pack Cruise	13.200,00 €
	2 x B&G Triton Displays (1 at chart table /1 at fly helmstation) with Speed-, Depth-, Wind-Transducer	
	2 x B&G Zeus 9" Chartplotter (1 at chart table /1 at fly helmstation)	
	B&G Autopilot, B&G Autopilot control unit (fly helmstation)	
	B&G V6U VHF incl. Antenna, AIS Transmitter/Receiver integrated (chart table)	
	B&G H60 wireless VHF unit (fly helmstation)	
<input type="checkbox"/>	Nav-Pack Advanced	17.800,00 €
	<i>includes Nav-Pack Cruise plus additional</i>	
	1 x extra B&G Autopilot control unit (1 at chart table /1 at fly helmstation)	
	2 x B&G Zeus 12" chartplotter instead of 9" (1 at chart table /1 at fly helmstation)	
	NMEA Connector for PC (chart table)	
	B&G Forward scan	
<input type="checkbox"/>	B&G camera under flybridge	1.950,00 €
<input type="checkbox"/>	B&G HALO 20+ Radar antenna	2.590,00 €
<input type="checkbox"/>	Pre installation for TV 220V in saloon (antenna and plug)	990,00 €
<input type="checkbox"/>	TV 220V in saloon incl. bracket, antenna	1.890,00 €
<input type="checkbox"/>	TV 220V in owner cabin incl. bracket, antenna	1.890,00 €
60 HZ OPTIONS		
<input type="checkbox"/>	Upgrade Electrical pack 110V	2.950,00 €
<input type="checkbox"/>	Watermaker 100L/h DUO- 12V/110V	16.900,00 €
<input type="checkbox"/>	Reversible air-conditioning 110V (cooling + heating function /outlet in saloon and each cabin)	26.400,00 €
<input type="checkbox"/>	Generator ONAN + monitoring 9KVA-60Hz under 110V	22.300,00 €
<input type="checkbox"/>	Inverter 2000W 110V connected to boardnet incl. Switch (Additional service batterie 140A and charger 40A compulsory)	2.380,00 €
<input type="checkbox"/>	Pre installation for TV 110V in saloon	990,00 €
<input type="checkbox"/>	Pre installation for TV 110V in owner cabin	990,00 €
<input type="checkbox"/>	Pre installation washing machine	390,00 €
<input type="checkbox"/>	Pre installation micro wave	180,00 €
SAFETY EQUIPMENT AND DELIVERY		
<input type="checkbox"/>	20kg Delta-Anchor, galvanized, chain Ø 10mm, length 70m with crow's feet	1.390,00 €
<input type="checkbox"/>	Dinghy 3,4m (Hypalon) with 15hp Honda outboard engine	10.900,00 €
<input type="checkbox"/>	6 pax life raft cat. A with security pack for 6 crew	3.990,00 €

<input type="checkbox"/>	12 pax Life raft cat. A with security pack for 12 crew	4.700,00 €
<input type="checkbox"/>	Antifouling SEAJET PRO (cold water)	3.550,00 €
<input type="checkbox"/>	Antifouling PLATINIUM (tropical water)	4.900,00 €
<input type="checkbox"/>	Copper coat	7.700,00 €
<input type="checkbox"/>	Delivery in La Rochelle Marina (1 week harbour incl.)	8.500,00 €
<input type="checkbox"/>	Preparation for seafreight (mast in 2 parts)	3.630,00 €
<input type="checkbox"/>	Administrative papers (without financing taxes and export fees except M21)	450,00 €

INDICATIVE RETAIL PRICE LIST

All prices are in EUROS EX Works Rochefort (17300 - France) Incoterms 2000
Version 2/2020 - Valid as of SEPTEMBER 8th 2020 - the previous price list loses its validity.
BASED ON BUILDER STANDARD SPECIFICATIONS SEPTEMBER 8th 2020

All weights and measurements are calculation based upon construction documents. The brochure is intended for advertisement only and is not part of a contract, warranty or of an offer. We reserve the right to modify or improve our products and to change its specifications without notice. We are not liable for errors and printing mistakes. All rights are reserved to execute alterations in construction and equipment without notice. Aforementioned prices are recommended sales prices for deliveries ex works within 4 months of order placement. Later deliveries are subject to invoicing according to the then valid price list. The current price includes the Ecotax APER.

NAUTITECH CATAMARANS, 5-7 rue Hubert Pennevert, 17300 Rochefort - France
Tél : +33 (0) 546 998 292
Email : contact@nautitech.fr
www.nautitechcatamarans.com



NAUTITECH 46 FLY

TECHNICAL STANDARD SPECIFICATIONS

SEPTEMBER 8th 2020



TECHNICAL DATAS

Length overall	13,79 m / 45'3"
Length waterline	13,71 m 45'0"
Beam overall	7,54 m / 24'9"
Draught	1,45 m / 4'9"
Unloaded weight (approx.)	11,4 t / 25.133 LBS
Engine, drive	Diesel, Saildrive
Engine power	x 50hp Volvo Pentax
Fuel tank	x 300L / 2 x 79 ga
Water tank	x 300L / 2 x 79 ga
Cabins - Heads, standard	3 to 4
Berths, standard Version	6 to 8
Full batten mainsail, standard	69 m ² / 743 sq ft
Self-tacking jib, standard	38 m ² / 409 sq ft
Height of mast above water Line (approx.)	22,9 m / 75'2"
Architect	Marc Lombard
Interior Design	Roseo Design

CE-Certification Category A (12 Pers.)

CE-Certification Category B (12 Pers.)

CE-Certification Category C (24 Pers.)

CE-Certification Category D (24 Pers.)

CONSTRUCTION

Hull and Deck made of fibreglass and polyester sandwich infusion -
VacuTec process

Hull and Deck in gelcoat white

Coachroof in gelcoat white & grey

Gold stripe on hull

Keel in GRP laminated and bonded to hull

4 x Double Hull windows including opening porthole

4 x Hull windows including opening porthole



RIG AND DECK HARDWARE

Aluminium deck stepped mast, anodised, with two spreaders sets
Aluminium boom, anodised
Running rigging
Mainsheet traveller on the coachroof
3 x Lewmar Evo aluminium winches 2-gear, self-tailing on flybridge
2 x Winches handles and pockets

■
■
■
■
■
■

SAILS

Full batten mainsail (3 reef Lines), Dacron
Self-tacking Solent in Dacron, incl. UV protection strip

■
■

DECK/ STERN PLATFORM

Guardrail on hull sides with stainless steel wires
2 x Forward pulpits
6 x Mooring cleats, aluminium
Anodised aluminium forward beam
Polyester safety net laced to hull and front beam
Bow anchor locker and storage
10 x openable deck hatches (1 additional in the 3 cabin Version)
Aft pushpits
2 x stainless steel handrails on stern
2 x Engine compartment hatches
Foldable bathing ladder on starboard

■
■
■
■
■
■
■
■
■
■
■
■
■

COCKPIT / TRANSOM

Spacious open style cockpit, 2 large benches on starboard and portside
Teak grating over cockpit drainage
Storage Locker
3 x large cockpit lockers
Liferaft locker in the aft beam

■
■
■
■
■

FLYBRIDGE

Access from cockpit via stairs on portside
Helm station with compass and stainless steel leather covered steering wheel
Electric engine throttle
Helmsman seat with foldable backrest
Rope bags
U-shaped settee
Adjustable sunbed backrest
Stainless steel handrail around flydeck
2 x stainless steel handrails on coachroof
Communication porthole between fly & salon

■
■
■
■
■
■
■
■
■
■

PROPULSION / STEERING

Soundproofing in engine compartments
2 x 50hp diesel engines Volvo Penta (Saildrive)
Diesel gauge
Alternators 115Ah (1 x per engine)
2 x 3-blade fixed aluminium propellers
GRP rudders with stainless steel stock
Emergency tiller

■
■
■
■
■
■
■

ELECTRICAL MANAGEMENT SYSTEM

1 x 12V / 140Ah services batterie
2 x 12V / 90Ah engine batteries (no maintenance)
12V Electrical panel at companion-way Portside
Gauge for service battery bank

■
■
■
■

LIGHTS

LED navigation lights and anchor Light
LED ceiling lights in cabins, bathrooms, saloon and cockpit

■
■

PLUMBING

2 x 85L holding tanks (one per hull / 65L in owner cabin)
2 x 300L freshwater tanks
Warm water boiler via engine-cooling, 60L
Pressurised water system
Indicator for freshwater
Electric and manual bilge pumps in both hulls
Electric bilge pumps in both engine compartments



INTERIOR LAYOUTS

Available Versions

4 Cabins

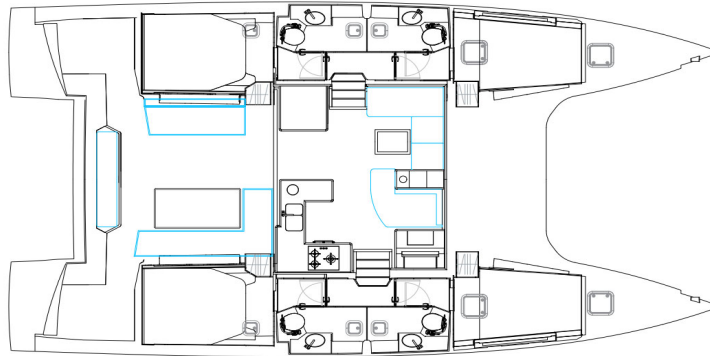

3 Cabins - Owner Version

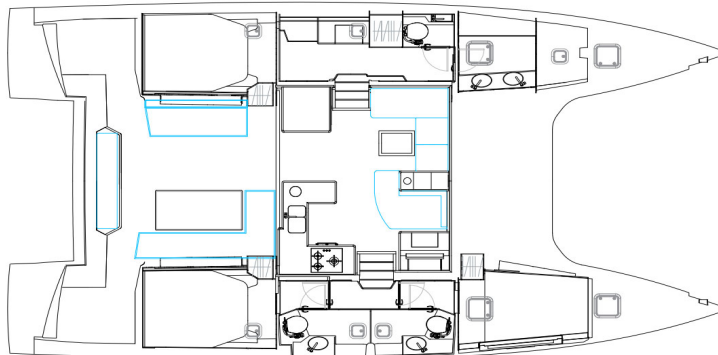

Generalities

Interior woodwork in walnut
Light walnut flooring
GRP - White
Ceiling liner Silvertex ICE
Vertical roof frame, black
Horizontal roof top frame, white plywood
Saloon baseboard, black

Saloon

Comfortable saloon area with a lounge style sofa on port
Large daybed on starboard with storage (1 locker & 1 drawer)
Storage under the seats
Fabric upholstery
Mast pillar black leather covered
Stainless steel handrail
Double sliding doors, Lockable
Deckhouse windscreen with 2 integrated hatches



Galley

Numerous storage cupboards
Large worktop (standard HPL compact white with kerrock fiddle)
2-drawer stainless steel fridge, 182L portside
4 burner gas stove
Separate Gas oven
Double sink with mixer tap
Waste bin

Cabins

Aft cabins with Double bed (160*200cm)
Forward cabins with Double bed (140/165*200cm)
Mattresses light grey with washable cover
Fabric covered finish at bed front
Underbed drawer
Several lockers and shelves for storage
Wall unit
Shelves onboard side
Side lining Silvertex ICE
12V LED reading lights headboard
Opening portlight in hull window (1 per cabin)
Opening deck hatch (1 per cabin)
Opening porthole in aft cabins above bed heads

Owner Cabin equipment (in addition to above cabin description)

Access from the saloon through a sliding door
Working area : desk with seat
Large lockers with three doors
Opening deck hatch

Head (1 per cabin)

Separate shower cabin (incl. mixing tap and support)
Sink with mixing tap
Black worktop (standard HPL compact)
Cabinet for storage
Towel rail
Mirror
Pump-toilet, manual
Opening portlight
Opening deck hatch

Owner head

Separate shower cabin (incl. mixing tap and support)
Double sink with mixer tap
Large cabinets for storage
Black worktop (standard HPL compact with kerrock fiddle)
Mirrors with integrated storage
Towel rail
Separate toilet
Pump toilet, manual
Opening portlight
2 x Opening deck hatches

Passage way

Storage cupboards

All weights and measurements are calculations based upon construction documents. The brochure is intended for advertisement only and is not part of a contract, warranty or of an offer. We reserve the right to modify or improve our products and to change specifications without notice. We are not liable for errors and printing mistakes. All rights are reserved to execute alterations in construction and equipment without notice. Aforementioned prices are recommended sales prices for deliveries ex works within 4 months of order placement. Later deliveries are subject to invoicing according to the then valid priceList.